

MPL 56, MPL 58 // Mounting plates

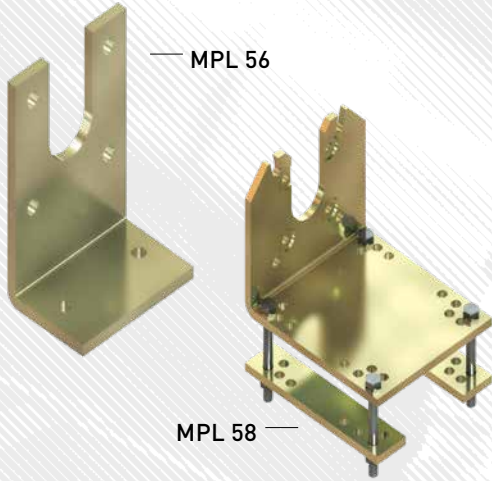

- Angled mounting plates for transverse mounting of EWA.
- MPL 56 for welding or bolting to beams or supports.
- MPL 58 for clamping to supports, e.g. in Venlo structures, variable for use with various support dimensions.
- Due to the clamping function, no additional drilling is required for the MPL 58.

MPL 56
for EWA 10–EWA 14

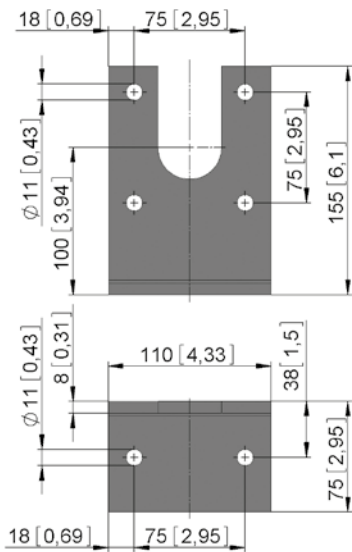

MPL 58
for EWA 10–EWA 16

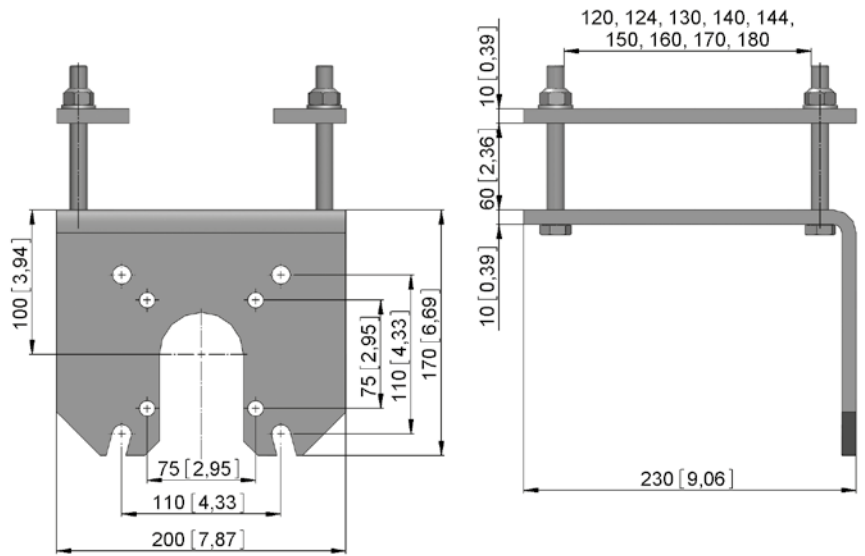

mm [inch]

| Version | Type no. | Info | m [kg] |
|-------------|-----------------|-----------------------------------|--------|
| MPL 56.1114 | 82556.1115.11 | EWA 10/12/14 | 1,3 |
| MPL 58.2009 | 82558.2017.0971 | EWA 10/12/14/16, only angle plate | 5,2 |
| MPL 58.2011 | 82558.2017.11 | EWA 10/12/14/16 | 8,1 |