

# WRO 22, WRV 50 // Roller tube, roller tube connector

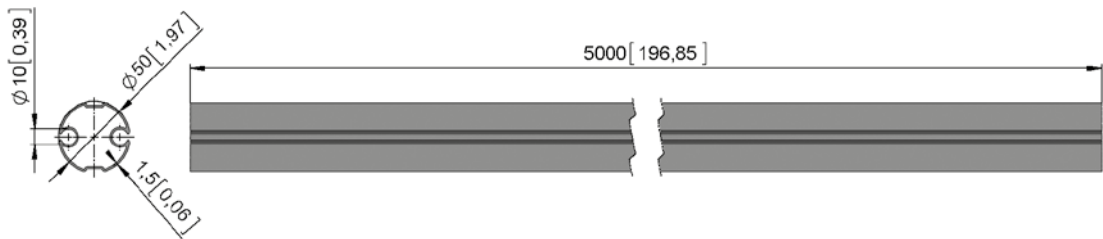

- Roller tubes and roller tube connector for use e.g. with VariVent®.
- WRO 22.5015: Aluminium roller tube  $\varnothing$  50 mm with key groove  $\varnothing$  10 mm on both sides, also suitable for RMA tube motors.
- WRV 50.2246: Roller tube connector for roller tube  $\varnothing$  50 mm.
- WRV 50.2260: Roller tube connector for roller tube  $\varnothing$  63 mm on RMA 20.1212.

WRO 22.5015



WRV 50.2246



WRV 50.2260

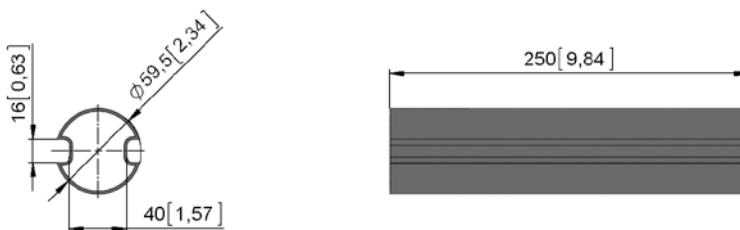

mm [inch]

| Version     | Type no.        | L [mm] | m [kg] |
|-------------|-----------------|--------|--------|
| WRO 22.5015 | 81622.5015.1050 | 5000   | 4,3    |
| WRV 50.2246 | 81650.2246.2004 | 385    | 0,2    |
| WRV 50.2260 | 81650.2260.2010 | 250    | 0,3    |